

**SPECIFICATIONS:-**

<b>FREQUENCY</b>	<b>Rx</b>	<b>10.70-11.70 GHz</b>
	<b>Tx</b>	<b>12.75-14.50 GHz</b>
<b>PORT TO PORT ISOLATION</b>	<b>Rx</b>	<b>35 dB MIN.</b>
	<b>Tx</b>	<b>65 dB MIN.</b>
<b>INSERTION LOSS</b>	<b>Rx</b>	<b>0.4 dB MAX.</b>
	<b>Tx</b>	<b>0.2 dB MAX.</b>
<b>RETURN LOSS</b>	<b>Rx</b>	<b>15 dB MAX.</b>
	<b>Tx</b>	<b>17.70 dB MAX.</b>
<b>CROSS-POL ISOLATION</b>	<b>Rx</b>	<b>&gt; 30 dB</b>
	<b>Tx</b>	<b>&gt; 30 dB</b>
<b>VSWR</b>	<b>Rx</b>	<b>1.43:1</b>
	<b>Tx</b>	<b>1.3:1</b>
<b>F/D RATIO</b>		<b>0.8</b>
<b>POWER</b>		<b>1 KW CW</b>
<b>PORT</b>		<b>2</b>

REVISIONS			
REV.	DESCRIPTION	DATE	APPROVED
A	RELEASED FOR TESTING	2/25/2014	RF

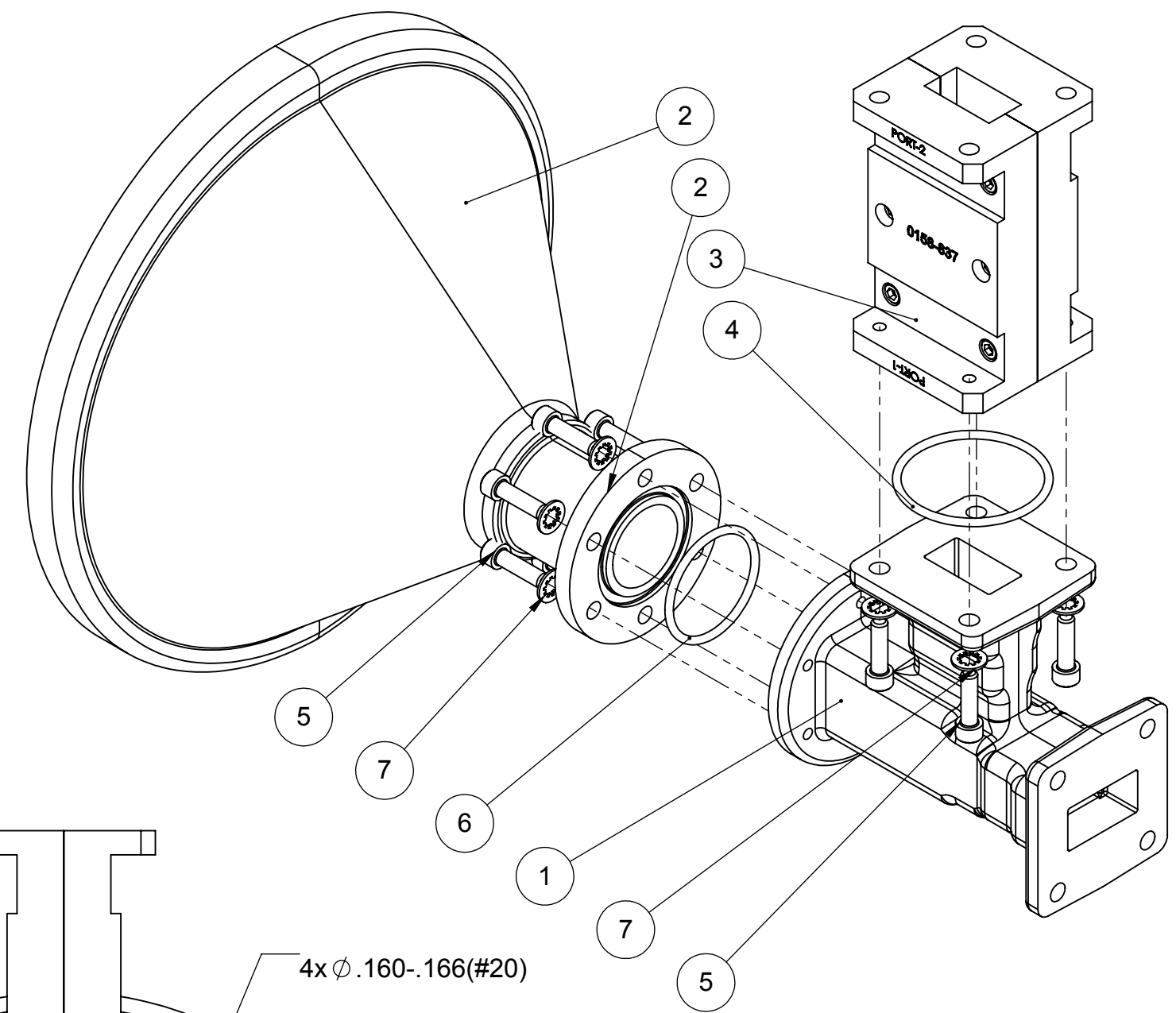
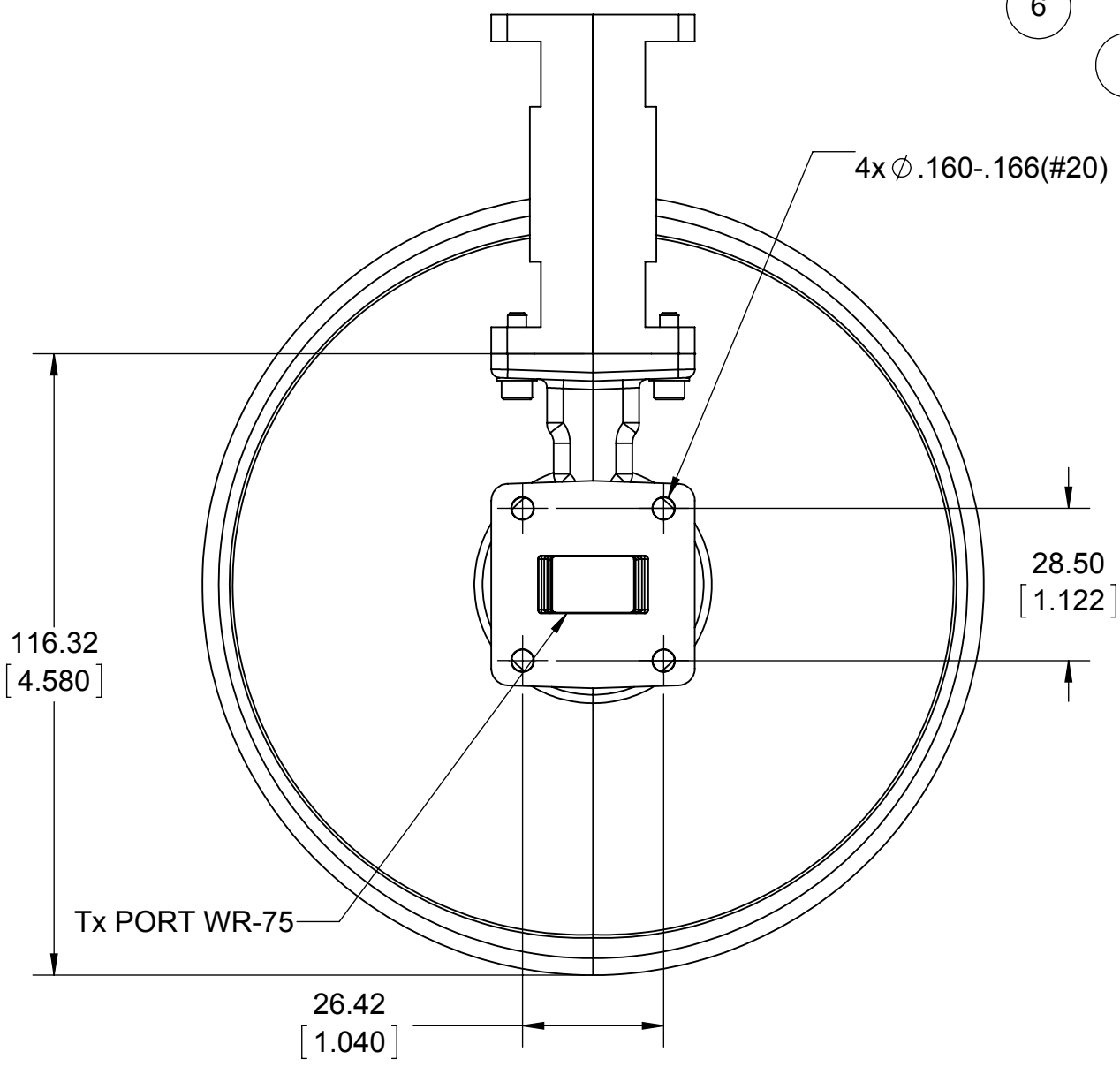
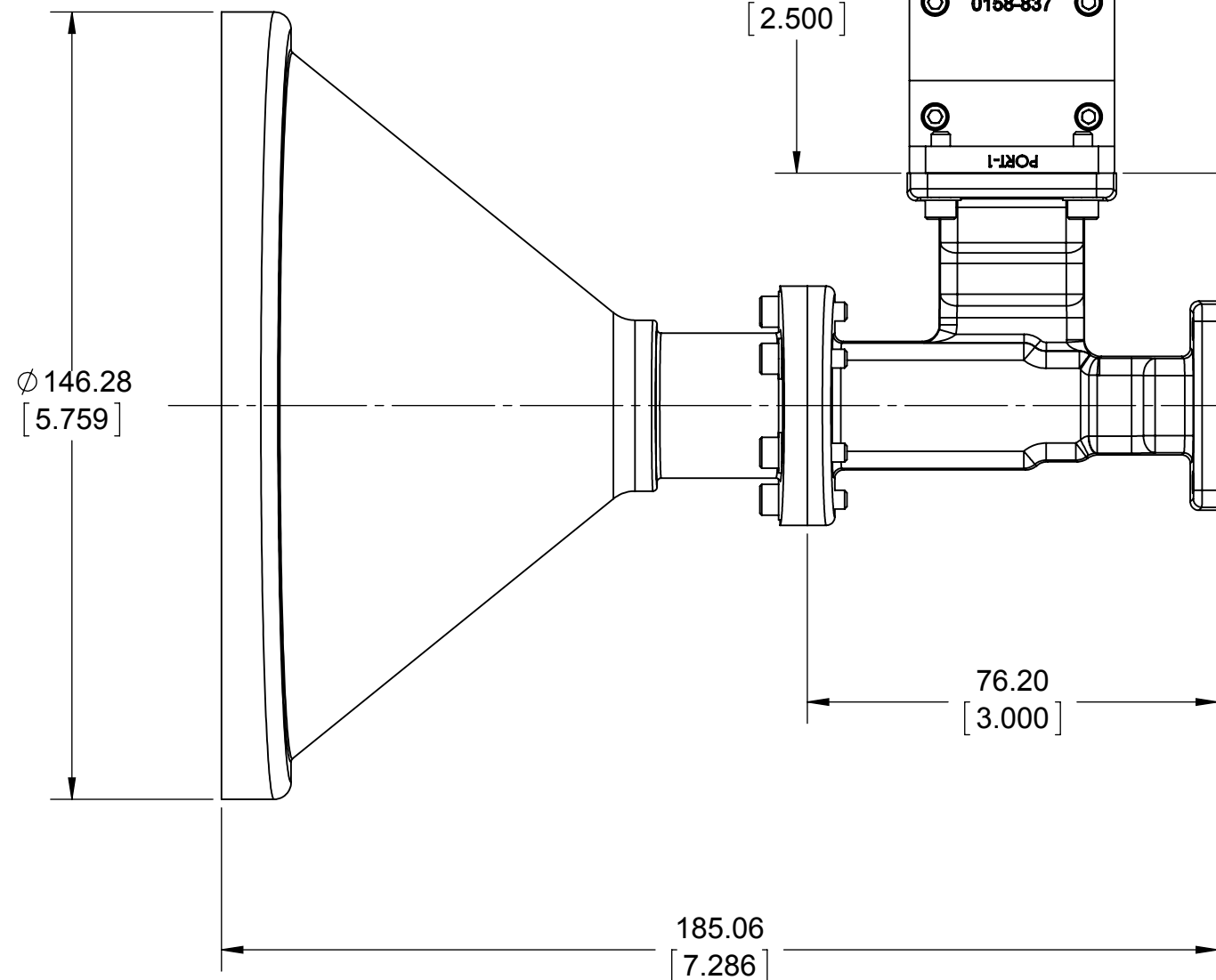
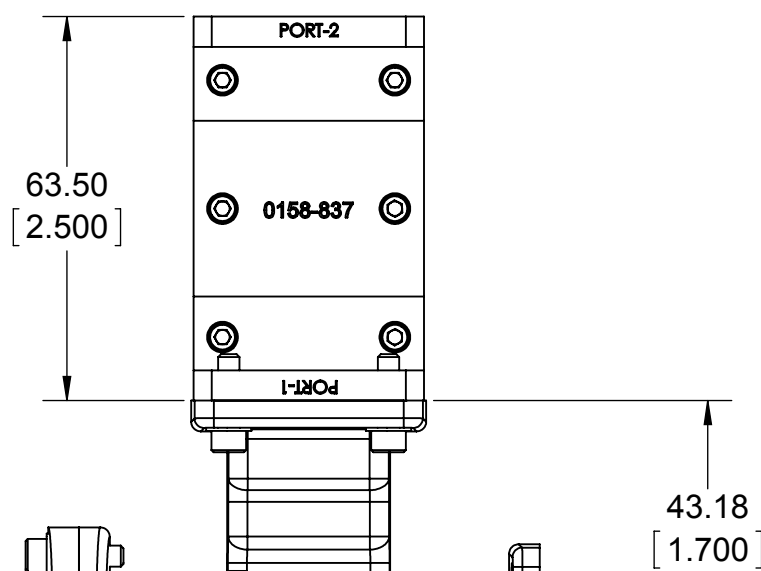
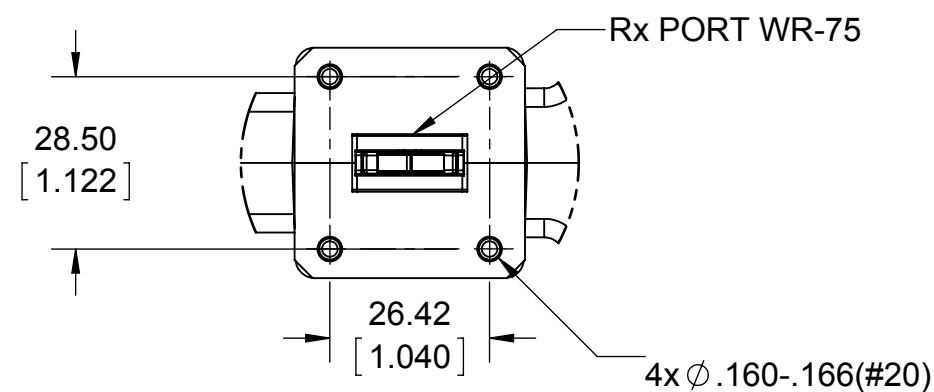

7	8200-010	LW #6 INTERNAL TOOTH SS	10
6	0198-120	O RING .926 ID X .067	1
5	8300-002	SCR SHCS #6-32 X .50 SS	10
4	0198-121	O-RING, 1.176ID X .070	1
3	0183-1337	Assy,Ku-Band TRF	1
2	4080-063	CSTG 39 DEG FD HORN MACHINED	1
1	4080-259	CSTG KU-BND OMT BROADBND RX	1
ITEM NO.	PART NUMBER	DESCRIPTION	QTY.



TITLE  
**ASSY, LOW FREQ. Ku BAND FEED**

MATERIAL	SEE NOTE	FINISH	SEE NOTE
NEXT ASS'Y		CODE IDENT. NO.	94661
DRAWN	02/25/2014 BY SS	0183-5054	REV. A
CHECKED	02/25/2014 BY RF		
ENGR.	02/25/2014 BY RF		
MFG APVD	BY	SCALE	0.8:1 SH. 1 OF 1

DIMENSIONS ARE IN MILLIMETERS. UNLESS OTHERWISE NOTED. TOLERANCES ON FINISHED DIMENSIONS ARE AS FOLLOWS:  
X = 2.0 X.XX = 0.3  
X.X = 1.0 ANGULAR = 1°

Prodelin's drawings, sketches, computer programs, plans, specifications, technical data, prototype products, blueprints, photographs, instructions, diagrams, models, formulae, tables, engineering designs, diskettes, tapes, software, other electronic media (defined to include, but not be limited to, the system functional design, logic flow, algorithms, application programs, operating systems, software design implementation, tests, test results, operation, diagnosis, repair...) and/or documents (collectively "Proprietary Materials") are confidential and proprietary in nature and are considered by it to constitute "trade secrets" as defined by N.C. Gen. Stat. 66-152 (3)(a) and (b) of the North Carolina Uniform Trade Secrets Act, by the Uniform Trade Secrets Act and by any other states/countries' Trade Secrets Acts regardless if some of the information or documents that were incorporated into such drawings, sketches, computer programs, plans, specifications, technical data, prototype products, blueprints, photographs, instructions, diagrams, models, formulae, tables, engineering designs, diskettes, tapes, software, other electronic media (defined to include, but not be limited to, the system functional design, logic flow, algorithms, application programs, operating systems, software design, implementation, tests, test results, operation, diagnosis, repair...) and/or documents or the information that was incorporated onto the Proprietary Materials came from a customer or third party and whether such Proprietary Materials do or do not constitute intellectual property, patent, trademark or copyright rights or material. THESE "PROPRIETARY MATERIALS" MAY NOT BE COPIED, REPRODUCED, DISCLOSED OR DISTRIBUTED IN WHOLE OR IN PART TO OTHER PARTIES EITHER VERBALLY OR IN WRITING WITHOUT PRIOR WRITTEN APPROVAL BEING OBTAINED FROM THE PRODELIN DOCUMENTATION SUPERVISOR OR A DULY AUTHORIZED REPRESENTATIVE.

3D STORED AT: C:\Users\singh\Desktop\Spec Sheet\0183-5054 revA